

RESOLUTION NO. 25545

A RESOLUTION AUTHORIZING GREG ROSS TO USE TEMPORARILY ROSSVILLE AVENUE TO INSTALL FOUR (4) GEOTHERMAL WELLS, AS SHOWN ON THE DRAWINGS ATTACHED HERETO AND MADE A PART HEREOF BY REFERENCE, SUBJECT TO CERTAIN CONDITIONS.

BE IT RESOLVED BY THE CITY COUNCIL OF THE CITY OF CHATTANOOGA, TENNESSEE, That Greg Ross (hereinafter referred to as "Temporary User") be and is hereby permitted to use temporarily Rossville Avenue to install four (4) geothermal wells, as shown on the drawings attached hereto and made a part hereof by reference.

BE IT FURTHER RESOLVED, That said temporary usage shall be subject to the following additional conditions:

1. Temporary User shall be responsible for repairs to the existing sidewalk in the right-of-way due to the above-referenced installation and repairs must be done per City standards and code.
2. Temporary User shall, prior to any work in the right-of-way, contact the proper authorities (One Call) for the purpose of identifying any underground utilities.
3. Temporary User shall execute the Indemnification Agreement attached hereto in favor of the City of Chattanooga, its officers, agents and employees for any and all claims for damages for injuries to persons or property related to or arising out of the temporary usage.
4. Temporary User agrees to vacate the property and temporary use upon reasonable notice from the City to do so.
5. Temporary User shall provide adequate access for maintenance of any utilities located within the easement.

ADOPTED: May 27, 2008

INDEMNIFICATION AGREEMENT

This Indemnification Agreement is entered into by and between THE CITY OF CHATTANOOGA, TENNESSEE (hereinafter the "City"), and GREG ROSS (hereinafter "Temporary User"), this 27 day of May, 2008.

For and in consideration of the granting of the temporary usage of Rossville Avenue to install four (4) geothermal wells, as shown on the drawings attached hereto and made a part hereof by reference, the receipt of which is hereby acknowledged, Temporary User agrees as follows:

1. Temporary User shall be responsible for repairs to the existing sidewalk in the right-of-way due to the above-referenced installation and repairs must be done per City standards and code.
2. Temporary User shall, prior to any work in the right-of-way, contact the proper authorities (One Call) for the purpose of identifying any underground utilities.
3. Temporary User will defend, and hold harmless the City of Chattanooga, Tennessee, its officers, agents and employees from any and all claims for damages for injuries to persons or property related to or arising out of the aforementioned temporary use.
4. Temporary User will vacate the property and temporary use upon reasonable notice from the City to do so; the parties hereto agree that "reasonable notice" shall be deemed to be thirty (30) days. Temporary User will restore the property to its original condition when it is returned to the City.
5. Temporary User will provide adequate access for maintenance of any utilities located within the easement.

GREG ROSS

_____, 2008
Date

BY: _____

[Signatures continued on next page.]

CITY OF CHATTANOOGA, TENNESSEE

06/02/08, 2008
Date

BY:

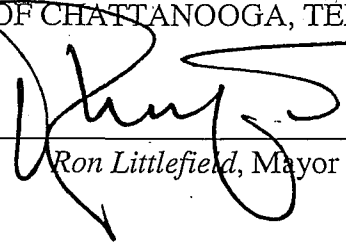

Ron Littlefield, Mayor

/add

collier construction
www.collierbuild.com

08.19.2008 11:10



3-4 LOCATIONS

63 MAIN ST.

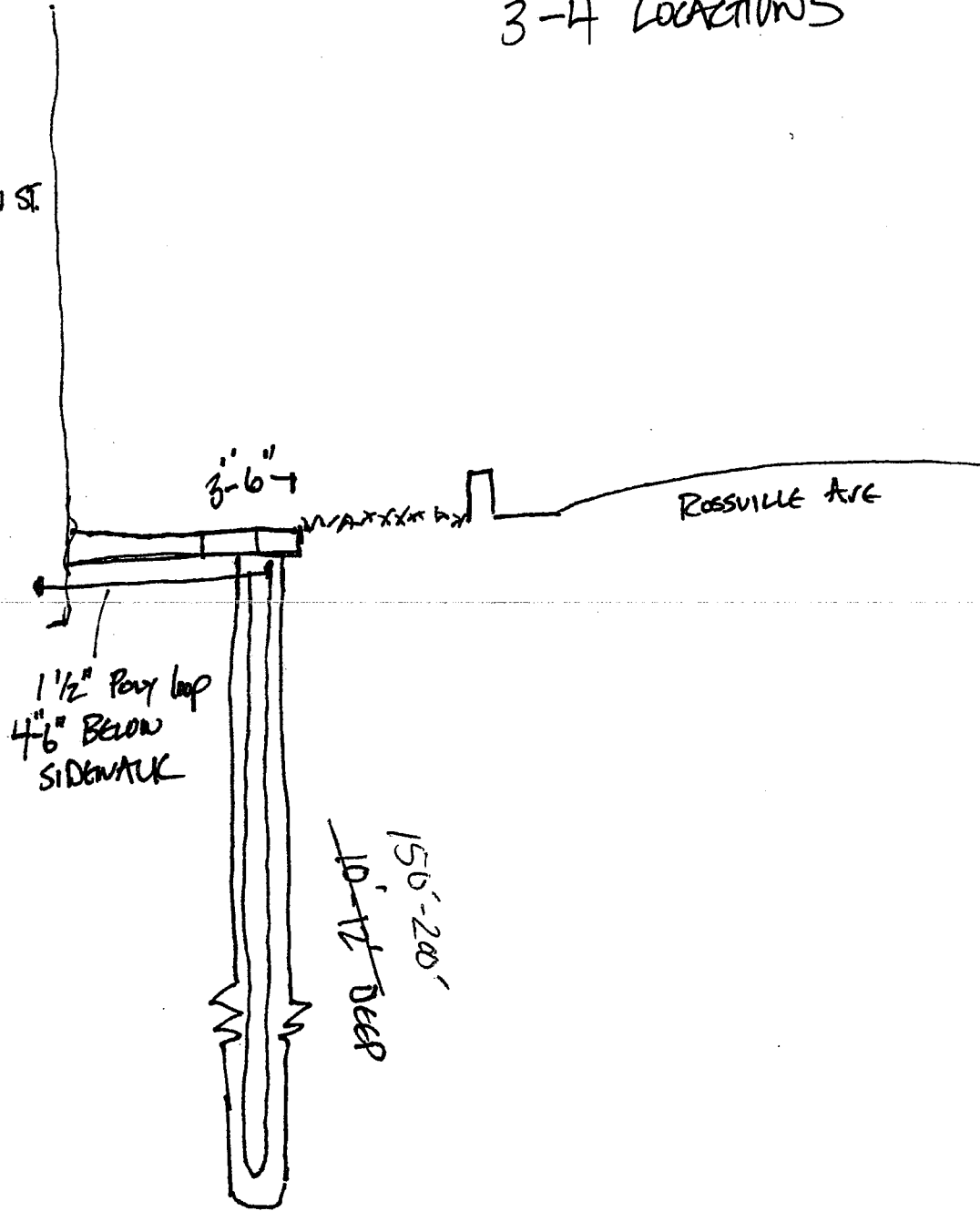

3'-6"

ROSSVILLE AVE

1 1/2" Poly loop
4" x 6" BELOW
SIDEWALK

15'-200'
~~10'-17'~~ DEEP



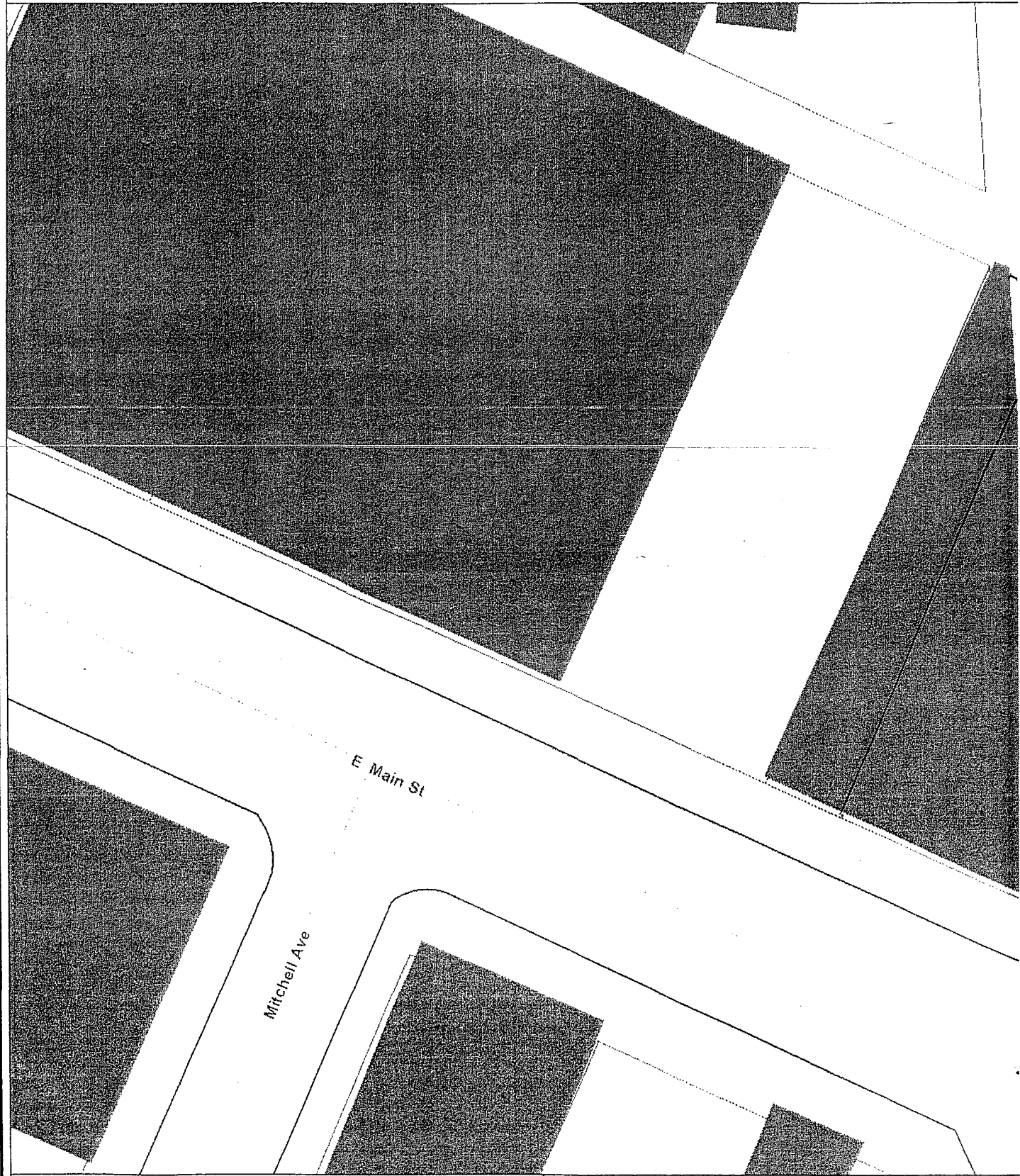



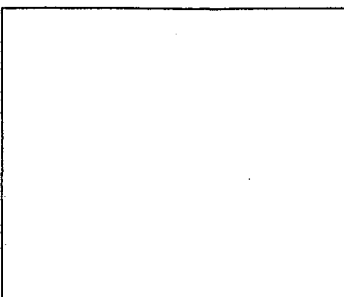

HCGIS - Internet Mapping Service



This map is a user generated static output from an Internet mapping site and is for general reference only. Data layers that appear on this map may or may not be accurate, current, or otherwise reliable. THIS MAP IS NOT TO BE USED FOR NAVIGATION.



Legend

-  Buildings
-  Interstates
-  Railways
-  CSW Structures
-  CSW Conveyances
-  Roads
-  Edge of Road Surface
-  Parcels cover
-  Water Bodies

Well Location
Johnson St

Map center: 35° 28' 36.91" N 85° 18' 19.82" W



Scale: 1:363

